



HOUSE of REPRESENTATIVES

STATE OF MICHIGAN

Appropriations Requests for Legislatively Directed Spending Items

1. The sponsoring representative's first name:
John
2. The sponsoring representative's last name:
Roth
3. The cosponsoring representatives' names. All cosponsors must be listed. If none, please type 'n/a.' A signed letter from the sponsor approving the co-sponsorship and a signed letter from the member wishing to co-sponsor are required. Attach letters at question #9 below.
n/a
4. Name of the entity that the spending item is intended for:
Northwestern Michigan College
5. Physical address of the entity that the spending item is intended for:
1701 E Front St., Traverse City, MI 49686
6. If there is not a specific recipient, the intended location of the project or activity:
n/a
7. Name of the representative and the district number where the legislatively directed spending item is located:
Betsy Coffia 103
8. Purpose of the legislatively directed spending item. Please include how it provides a public benefit and why it is an appropriate use of taxpayer funding. Please also demonstrate that the item does not violate Article IV, S 30 of the Michigan Constitution. This renovation project is critical for student efficiency, retention, and success/completion by allowing us to implement comprehensive wraparound services for our students in a "one-stop shop". Studies and experience have shown that implementing comprehensive wraparound services increases enrollment and completion rates, which ultimately supports the talent pipeline and the State's Sixty by 30 goal. This does not violate Article IV, S30 of the Michigan Constitution because NMC is a public institution.

9. Attach documents here if needed:

Attachments added to the end of this file.

10. The amount of state funding requested for the legislatively directed spending item.

8000000

11. Has the legislatively directed spending item previously received any of the following types of funding? Check all that apply.

["None"]

12. Please select one of the following groups that describes the entity requesting the legislatively directed spending item:

University/College

13. For a non-profit organization, has the organization been operating within Michigan for the preceding 36 months?

Not applicable

14. For a non-profit organization, has the entity had a physical office within Michigan for the preceding 12 months?

Not applicable

15. For a non-profit organization, does the organization have a board of directors?

Not applicable

16. For a non-profit organization, list all the active members on the organization's board of directors and any other officers. If this question is not applicable, please type 'n/a.'

n/a

17. "I certify that neither the sponsoring representative nor the sponsoring representative's staff or immediate family has a direct or indirect pecuniary interest in the legislatively directed spending item."

Yes, this is correct

18. Anticipated start and end dates for the legislatively directed spending item:

January 2025-January 2026

19. "I hereby certify that all information provided in this request is true and accurate."

Yes

Integrated Student Service Hub

Total Project Cost: \$8 million



Northwestern Michigan College

Summary

This project will transform Northwestern Michigan College's 57 year-old Osterlin Building on central campus into an integrated student service hub. The hub will efficiently serve student needs for admissions, financial aid, cashiers, advising, counseling, international outreach, health and veteran services. It features a dedicated Veterans Lounge, testing center, and talent development services area.

Features

- Key student needs centralized from 3 buildings to 1
- Reduced environmental footprint through use of sustainable technologies
- Integrates with regional talent development strategy
- Veterans Lounge
- Reduced operating costs
- Local matching funds (\$2.8m)
- No impact on tuition
- Last state funded capital project was 2018

Key Upgrades

- 26,000 ft.² renovation, includes demolition and reconstruction of 1st floor interior design
- HVAC modernization
- Energy efficient windows
- Exterior upgrades
- Improve ADA accessibility
- Lighting and electrical upgrades
- IT infrastructure upgrades
- Elevator upgrade

Renovated Floor Plan

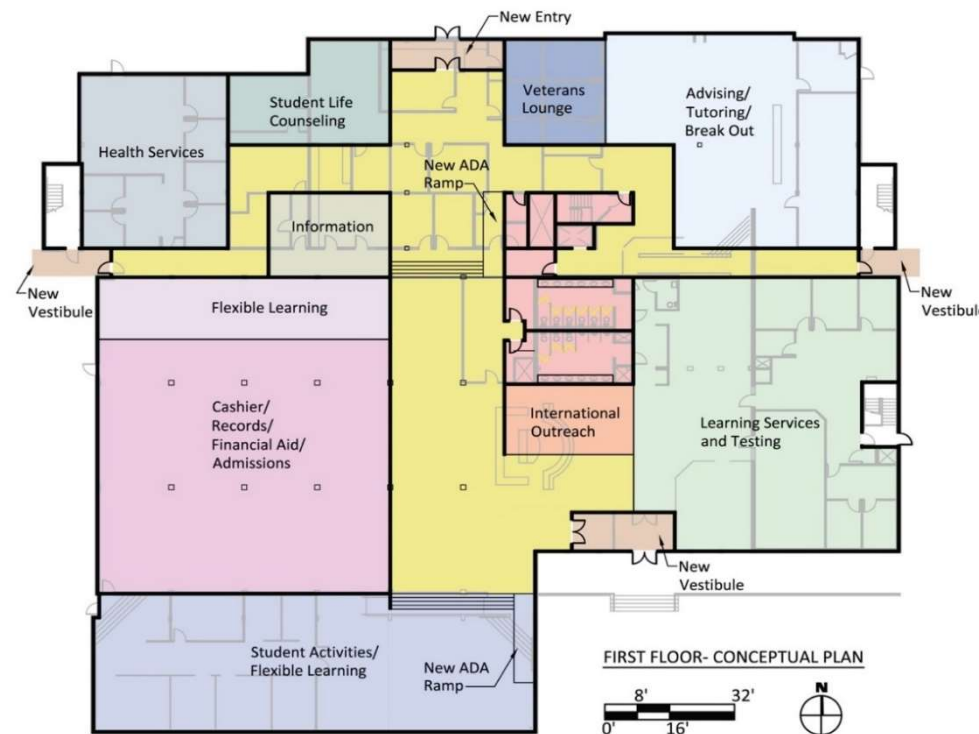

Current Condition



Osterlin Building – SE Exterior



Osterlin Building – Main Entrance



Osterlin Building – Student Success Ctr

Student Outcome

Increased student retention and completion due to an improved, holistic customer service experience via the Hub



Northwestern Michigan College